

Heart Box

INSTRUCTIONS PAGE 1

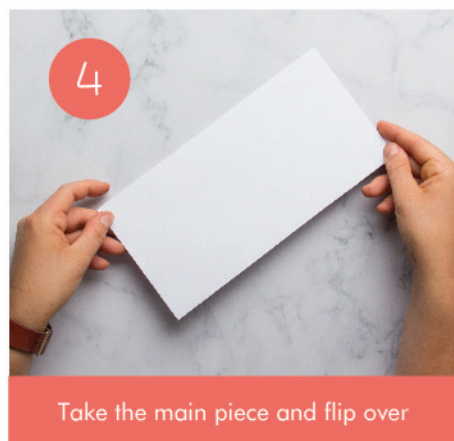
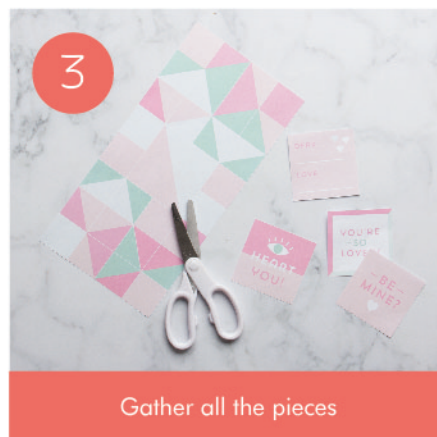

Heart Box

INSTRUCTIONS PAGE 2



13

Repeat on other side then open flat



14

Fold up from bottom like so



15

Fold corner into centre



16

Repeat on other side



17

Fold out flat



18

Fold corners in like so



19

Repeat on other side



20

Lay out flat



21

Fold sides into centre



22

Open top half with fingers, then fold from top down and press flat



23

Press down firmly like so



24

Tuck corner underneath

Heart Box

INSTRUCTIONS PAGE 3



25

Fold side into centre



26

Fold other side into centre



27

Fold up and press down flat



28

Rotate design then repeat steps 22 - 23



29

Flatten with fingers



30

Tuck corner underneath



31

Fold side into centre



32

Fold other side into centre



33

Fold up and press down flat

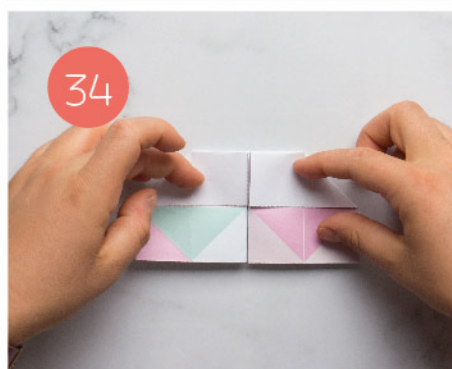

34

Rotate like so



35

Fold side into centre



36

Fold corner into centre

Heart Box

INSTRUCTIONS PAGE 4



37

Press firmly flat with finger



38

Fold corner tip over



39

Take the side...



40

Fold up into the centre

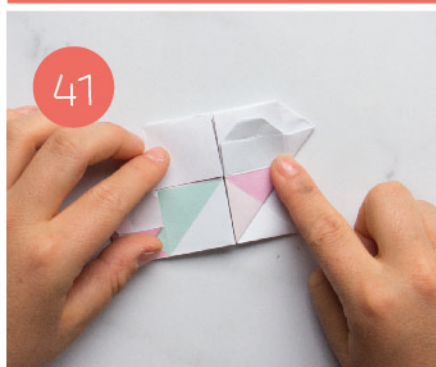

41

Flatten out firmly with fingers

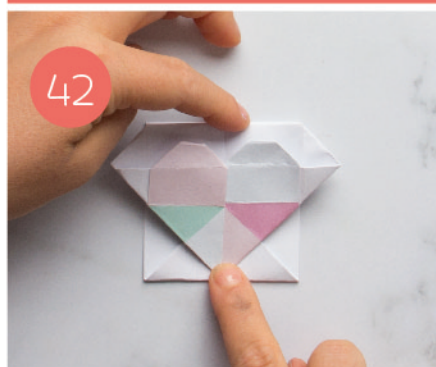

42

Repeat steps 35 - 41 on opp side

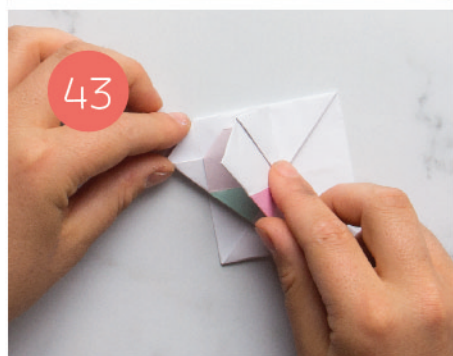

43

Fold hearts into each other



44

Rotate, then take side & bring to centre



45

Press flat, then tuck under flap

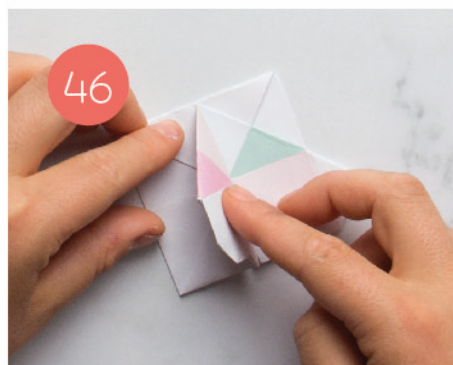

46

Repeat steps 43 - 45 other side

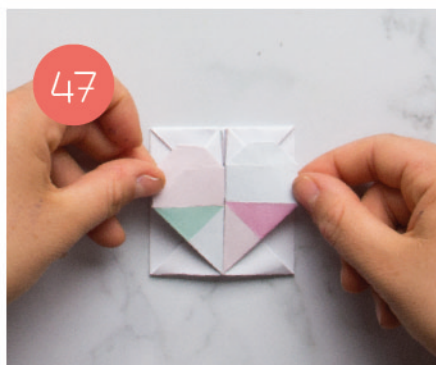

47

Press design flat



48

Pull sides with fingers to open!

Heart Box

INSTRUCTIONS PAGE 5



Choose your special quote



Insert into box. You can use glue if you wish!



Yay! Almost done...



Tie twine around your heart to keep it closed, then give it to your someone special!

Happy Valentines Day!

»» → WITH LOVE FROM TINYME ← ««